

Serie  
serie

SMx

## Magnetsensoren mit Impulsausgang ohne Reference



**AK Industries**

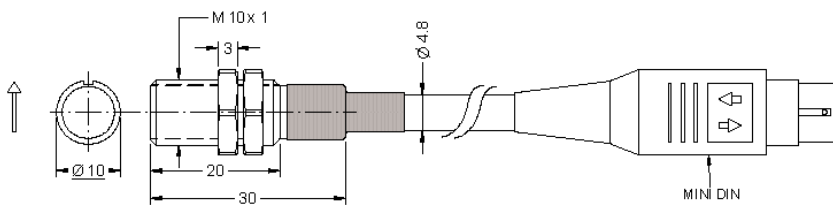
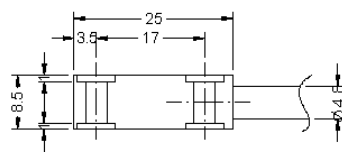
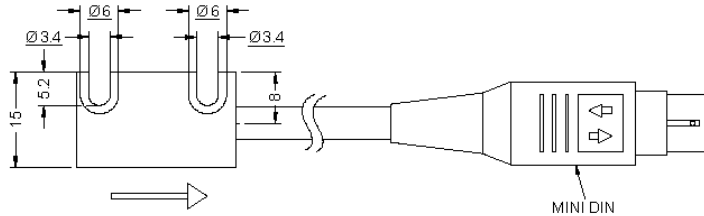

CE

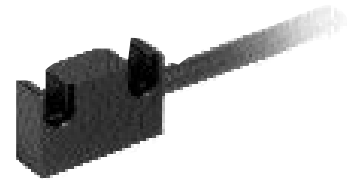

SM-R

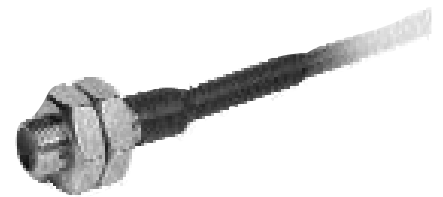

SM-C

### UMGEBUNGSBEDINGUNGEN - CARATTERISTICHE AMBIENTALI

Arbeitstemperatur/Temperatura di lavoro :	-10°C ÷ +70°C
Lagertemperatur/Temperatura di immagazz.:	-20°C ÷ +80°C
Schutzart/Protezione :	IP67

### MECHANISCHE EIGENSCHAFTEN - CARATTERISTICHE MECCANICHE

Abmessungen/Dimensioni :	s. Zeichnung/vedi disegno
Gehäuse/Contentitore :	Aluminium/Alluminio
Anschluss/Connessioni :	MiniDIN/MiniDIN
Kabellänge/Lunghezza cavo :	max. 20 m (SM25 max. 2,0 m)
Abstand Sensor-Magnetband/Distanza Sensore-Banda magnetica:	SM2 0,1 ÷ 1,0 mm (@ MT20) SM25 0,1 ÷ 1,0 mm (@ MT25) SM5 0,1 ÷ 2,0 mm (@ MT50)
Verfahrgeschwindigkeit/Velocità di spostamento :	max 16 m/s

### ZUBEHÖR - ACCESSORI

EBOX (SM5):	Auswertelektronik/Convertitore
LD120 (SM5):	LED Anzeige/Display LED
MC150 (SM2, SM5):	LED Anzeige/Display LED
LD140 (SM25):	Batterieanzeige/Display a batteria
MT20/MT25/MT50:	Magnetband/Banda magnetica
PS1:	Profilschiene/Profilo di protezione

### BESTELLSCHLÜSSEL / CODICE DI ORDINAZIONE

XXXX	-	X	XX
SERIE SERIE			
SM2 SM25 SM5			Kabellänge auf Wunsch z.B.: 2 = 2 Meter 7 = 7 Meter
SENSOR SENSORE			xx Lunghezza cavo a richiesta Es.: 2 = 2 metri 7 = 7 metri
Rechteckig/Rettangolare		R	
Zylindrisch/Cilindrico		C	